

10:38

LTE



schoolmessenger



SchoolMessenger

Intrado SchoolMessen...

Open

4.2★

2K reviews

100K+

The Blue SchoolMessenger app by Intrado in the Play store. In the iOS store it is by Reliance Communications.

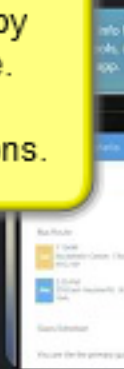
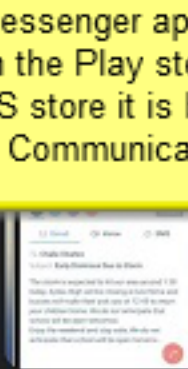

SchoolMessenger is a powerful way to stay connected to your school.

You might also like



Microsoft
Excel: View, E...
4.4★



Adobe Acrobat
Reader: PDF ...
4.6★



Microsoft
Word: Write, ...
4.4★

Similar apps



 LTE 

Email

byates@rise

Teachers use your RISD email, parents use the email the school has on record for you.

Password



[Forgot your password?](#)

Location

United S

Pick a memorable password, you may have to enter it often.

Log in

Not you? [Logout](#)

10:39

⊖ LTE  



Messages



Create your first message
You currently don't have any
messages.



12:22

🔇 🔒 LTE 📶 🔋



SCHOOLMESSENGER®

Bryan Yates

byates@risd.k12.nm.us



Messages



Contacts



Manage Groups



Join Groups



Preferences



Settings



Help



Logout

How are we doing?





Manage Groups

This is where Teachers see their classes. The classes, enrollments, and student Contacts are updated nightly.



You have no groups.

Create a group here and share the group code with any guardians or contacts you would like to join. Once members have joined, you can then send them a message!

Teachers and Staff can also create their own additional groups, if desired, as shown on next few slides.

[CREATE A GROUP](#)



10:39

⊖ LTE  



Manage Groups



Group/Class name:

Group Name 

CANCEL **CREATE**

you would like to join. Once
members have joined,
you can then send them a
message!

CREATE A GROUP



10:40

⊖ LTE  



Manage Groups

Group/Class name:

punny club



CANCEL

CREATE

any guardians or con
you would like to join

CREATE A GROUP



club

clubs

clubhouse



q

w

e

r

t

y

u

i

o

p

a

s

d

f

g

h

j

k

l



z

x

c

v

b

n

m



?123

,



10:40

⊖ LTE  



Manage Groups



This is your group access code:

WUZYSB

Share the above code with contacts and guardians you would like to join this group. Once they enter this code on the Contacts/Groups section on the website or app, they will be able to receive and send group messages.

Group/Class name:

punny club

10:41

⊖ LTE  



punny club



1 Group Member(s)



Bryan Yates

Teacher Guardian Contact

If you need to see that
code again, click up
on the gear.

10:41

⊖ LTE  



SCHOOLMESSENGER®

Bryan Yates

byates@risd.k12.nm.us



Messages



Contacts



Manage Groups



Join Groups



Preferences



Settings



Help



Logout

How are we doing?



VE GROUP

NG A CODE

10:41

⊖ LTE  



Join Groups

punny club
Roswell ISD

LEAVE GROUP



JOIN A GROUP USING A CODE



10:41

⊖ LTE  



Join A Group



Type your group access code:



Once you have joined a group, you should be able to receive and send messages.

Don't have a code?

Please ask the teacher to share with you the access code of the group you would like to join.

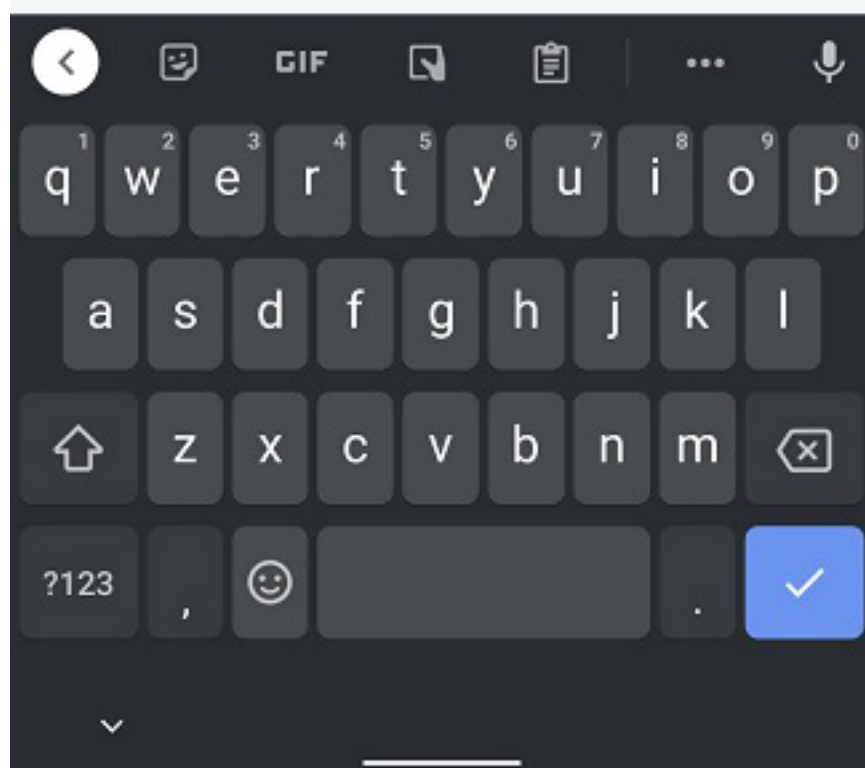

10:40

⊖ LTE  



Manage Groups



This is your group access code:

WUZYSB

Feel free to join my club.

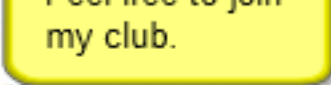

Share the  with contacts and guardians you would like to join this group. Once they enter this code on the Contacts/Groups section on the website or app, they will be able to receive and send group messages.

Group/Class name:

punny club

11:12

⊖ LTE  



punny club



2 Group Member(s)



Christopher McDonald
Guardian



Bryan Yates
Teacher Guardian Contact

12:22

🔇 🔒 LTE 📶 🔋



SCHOOLMESSENGER®

Bryan Yates

byates@risd.k12.nm.us



Messages



Contacts



Manage Groups



Join Groups



Preferences



Settings



Help



Logout

How are we doing?



10:39

⊖ LTE  



Messages



Create your first message
You currently don't have any
messages.



11:13

⊖ LTE  



New Message



To:



Christopher McDonald



Bryan Yates



Hide recipients list



punny club



1 Contacts | 2 Guardians

Both

All

All

Try each of these buttons and you'll notice the names will change. Hopefully this will make more sense with a full class of contacts.

11:13

⊖ LTE  



New Message



Type your message



welcome punmasters

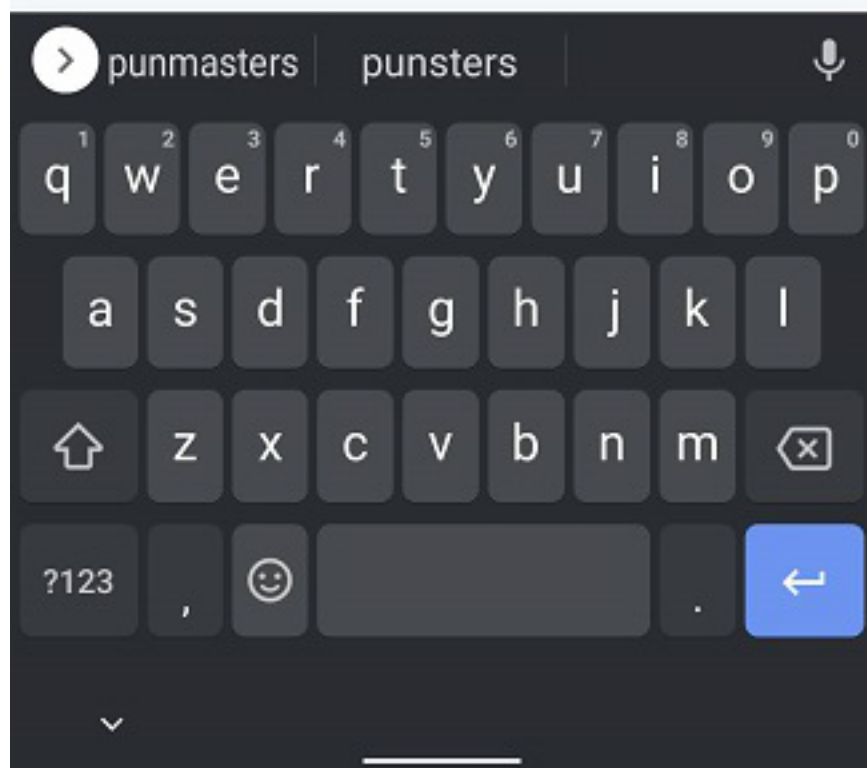

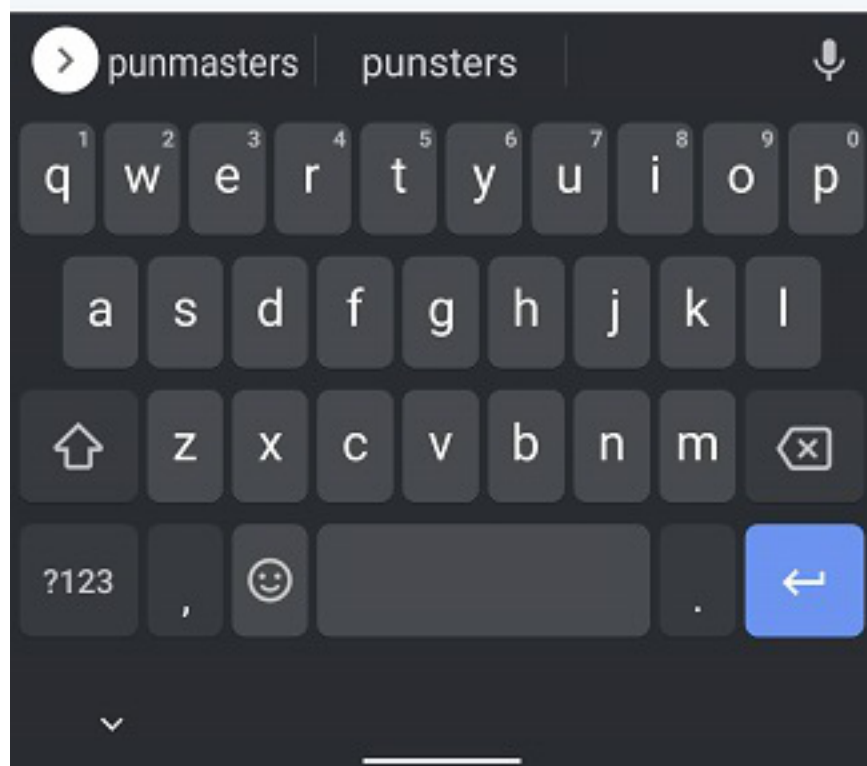
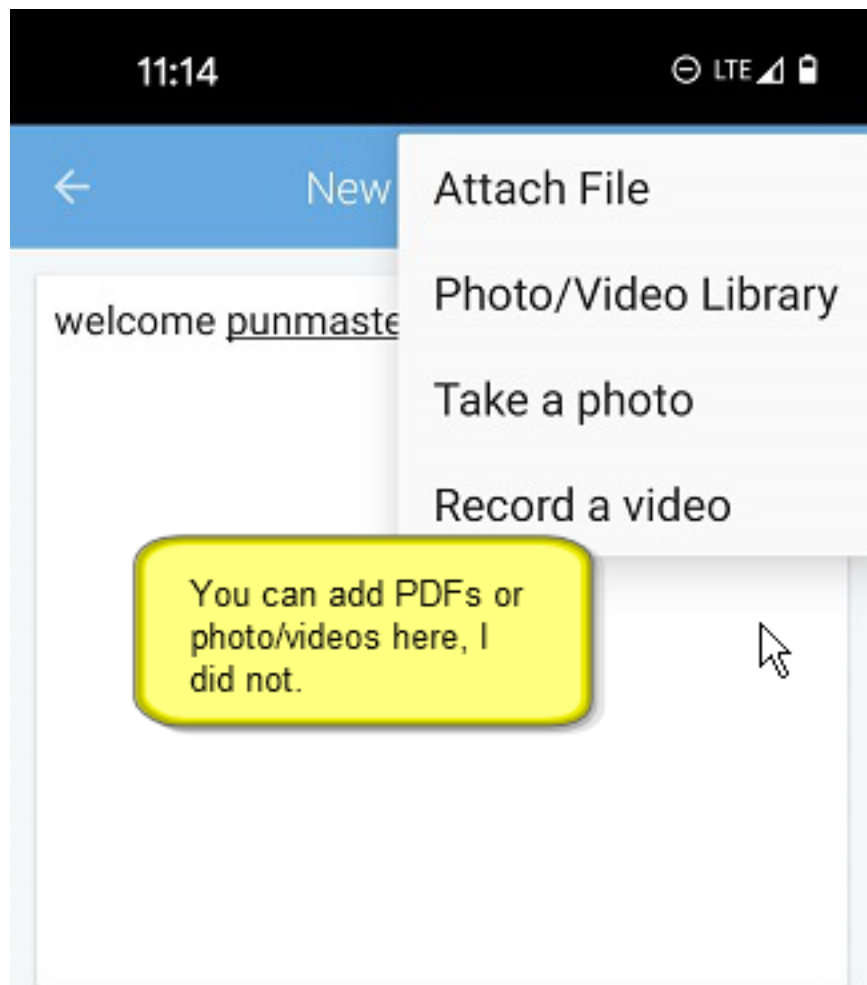

11:14

🔇 🚫 LTE 📶 🔋



New Message



welcome punmasters

**Comments/Replies will
be seen by:**

- ☒ The group
- ☐ Me privately
- ☐ Comments not allowed

SEND



Calls and notifications will vibrate

11:14

🔇 🚫 LTE 📶 🔋



Messages



Updated Today



**Bryan Yates >
Christopher McDonald**

just now

welcome punmasters



0



0



Public



11:20

🔇 🚫 LTE 📶 🔋



Message Details



Today



Bryan Yates > a minute ago
Christopher McDonald

welcome punmasters



0



1



Public



Bryan Yates just now
no comment

Leave a comment



11:30

🔇 🌐 LTE 📶 🔋



Message Details



Today



Bryan Yates > 15 minutes ago
Christopher McDonald

welcome punmasters



0



2



Public



Bryan Yates 15 minutes ago
no comment



Christopher McDonald 15 minutes ago

ok. now it shows up

Leave a comment



10:41

⊖ LTE  



SCHOOLMESSENGER®

Bryan Yates

byates@risd.k12.nm.us



Messages



Contacts



Manage Groups



Join Groups



Preferences



Settings



Help



Logout

How are we doing?



10:42

⊖ LTE  



Roswell ISD

Contact Preferences



(575) 555-1212



BYates@risd.k12.nm.us

Message Preferences

School Hours



Attendance



General



Survey



Non-school Hours



This screen shows green icons for each type of communication you can receive from TIM and SchoolMessenger Robocalls.

10:42

⊖ LTE  



School Hours Emergency

School Hours Emergency

Emergency notifications sent during school hours



Call me

☒ (575) 555-1212



Send me a text message

☒ (575) 555-1212



Send an email

☒ BYates@risd.k12.nm.us



You can't fix your own info, but you can toggle your settings on each of these detail screens.

- Teacher errors go to HR for correction.
- Parent errors are corrected by school office.

More download, FAQ and help
guides available at

[https://www.risd.k12.nm.us
/cms/one.aspx?pagelId=24972611](https://www.risd.k12.nm.us/cms/one.aspx?pagelId=24972611)